



# BENTZ BOATS

155 Southport Ave  
Lewiston ID. 83501  
Phone: (208) 746-7035  
Fax: (208) 750-0037  
bentzboats@bentzboats.com  
www.bentzboats.com

Plant Location - 155 Southport



## Guyana Triple Outboard

This triple Yamaha 300 outboard was built to access a private island on the Essequibo River in Guyana, South America. The size and power gives this high performance boat all that it needs to quickly transport numerous family and friends along with all their gear. Combination of booth, bus and outside swivel seating gives lots of seating preferences to guests. The outside seating is canopy covered to keep people dry from Guyana's rain forest environment. Top trays, in seat storage and in floor storage provide ample gear and luggage carriage. Yamaha provided "Command Link Plus" single vessel view screen for all 3 engines keeps the dash area uncluttered which is coupled to the electronic controls for ease of shift and throttle.

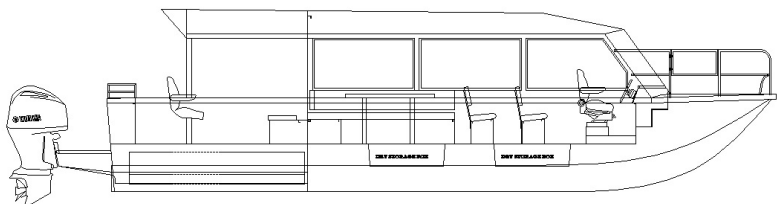
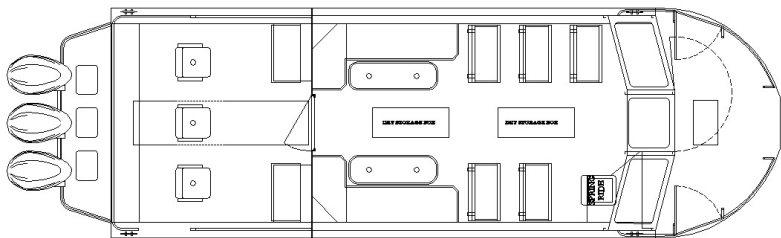

Bentz Boats has set the standard for quality and innovation for over 45 years. Since our 1st aluminum jetboat boat built in 1970 we have developed superior quality, efficient and agile handling boats. Through years of personal and commercial use, customer feedback and innovative designs, Bentz Boats has acquired a domestic and international clientele not only for our superior boat design but also our commitment to quality. Attention to detail and a high quality build standard makes Bentz Boats extremely tough with a high degree of impact resistance and helps ensure that each boat operates with a minimum of maintenance.

Bentz Boats has developed our hull designs to operate in the conditions specific to each customer. From shallow, fast running rivers to open salt-water conditions. Each boat is designed with passenger comfort, stability and safety in mind.

## SPECIFICATIONS

**Owner:** Private Recreation  
**Home Port:** Parika, Guyana, SA

**Designer:** Bryan Bentz  
**Builder:** Bentz Boats, LLC

**Construction Material:** Aluminum

**Length:** 35'-0"

**Bottom:** 10'

**Beam:** 12'

**Engines:** 3-Yamaha 300

**Maximum Speed:** ~ 55 knots (light ship)

**Cruising Speed:** ~ 35 knots

**Fuel:** 240 Gallon gasoline

*Often Imitated, Never Duplicated*



# BENTZ BOATS

155 Southport Ave.  
Lewiston ID. 83501  
Phone: (208) 746-7035  
Fax: (208) 750-0037  
bentzboats@bentzboats.com  
www.bentzboats.com

Plant Location - 155 Southport



*Often Imitated, Never Duplicated*