



BENTZ BOATS

155 Southport Ave.
Lewiston ID. 83501
Phone: (208) 746-7035
Fax: (208) 750-0037
bentzboats@bentzboats.com
www.bentzboats.com

Plant Location - 155 Southport



"Dreadnaught" 35' Twin Diesel

Alaska Water's boat "Dreadnaught" is powered by twin Cummins QSB6.7, 425 hp diesel engines and coupled to Hamilton 274's. Features include forward spring ride seats, combination bus and bench seats, top trays, dual heaters, pantograph wipers, full instrumentation, welded rear rails, dome lights and Coast Guard approved running and navigation lights. Extra's include spot and flood lights, galley and head with running water, complete navigation electronics package, IBA, EPIRB, satellite phone, battery charger, VHF and CB radios, custom PA system, radar tower, canoe racks

Bentz Boats has set the standard for quality and innovation for over 35 years. Since our 1st aluminum jetboat boat built in 1970 we have developed superior quality, efficient and agile handling boats. Through years of personal and commercial use, customer feedback and innovative designs, Bentz Boats has acquired a domestic and international clientele not only for our superior boat design but also our commitment to quality. Attention to detail and a high quality build standard makes Bentz Boats extremely tough with a high degree of impact resistance and helps ensure that each boat operates with a minimum of maintenance.

Bentz pioneered features include the sled shaped bow, forward and center pilot station, short stroke mechanical stick steering and delta pad bottom. These features contribute to our boats' superior handling, quick planing and shallow running capabilities.

SPECIFICATIONS

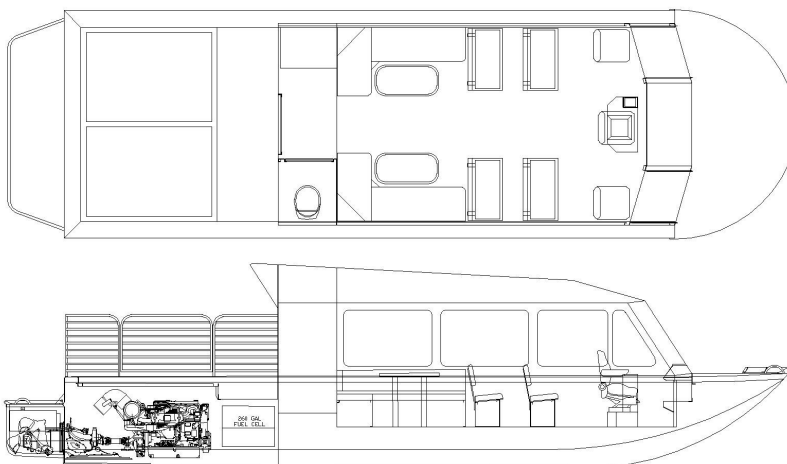

Owner: Jim Leslie
Alaska Waters

Home Port: Wrangell, Alaska

Designer: Bryan Bentz

Builder: Bentz Boats, LLC

Construction Material: Aluminum

Length: 35'-0"

Bottom: 9'

Beam: 11'

Draught: 10"

Engines: 2-Cummins QSB6.7 425hp

Jet Units: 2-274 Hamilton Jet

Impellers: 11Kw Impellers

Maximum Speed: ~ 50 mph

Cruising Speed: ~ 35 mph

Fuel: 260 Gallon Diesel

Often Imitated, Never Duplicated



BENTZ BOATS

155 Southport Ave
Lewiston ID. 83501
Phone: (208) 746-7035
Fax: (208) 750-0037
bentzboats@bentzboats.com
www.bentzboats.com

Plant Location - 155 Southport



Often Imitated, Never Duplicated